

(1, 1)

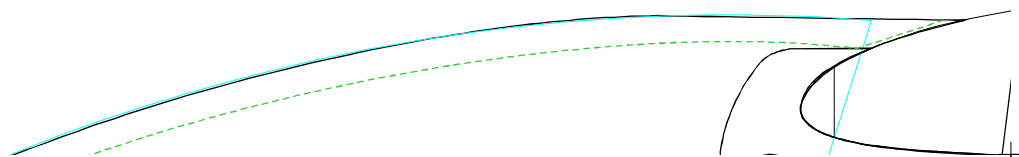

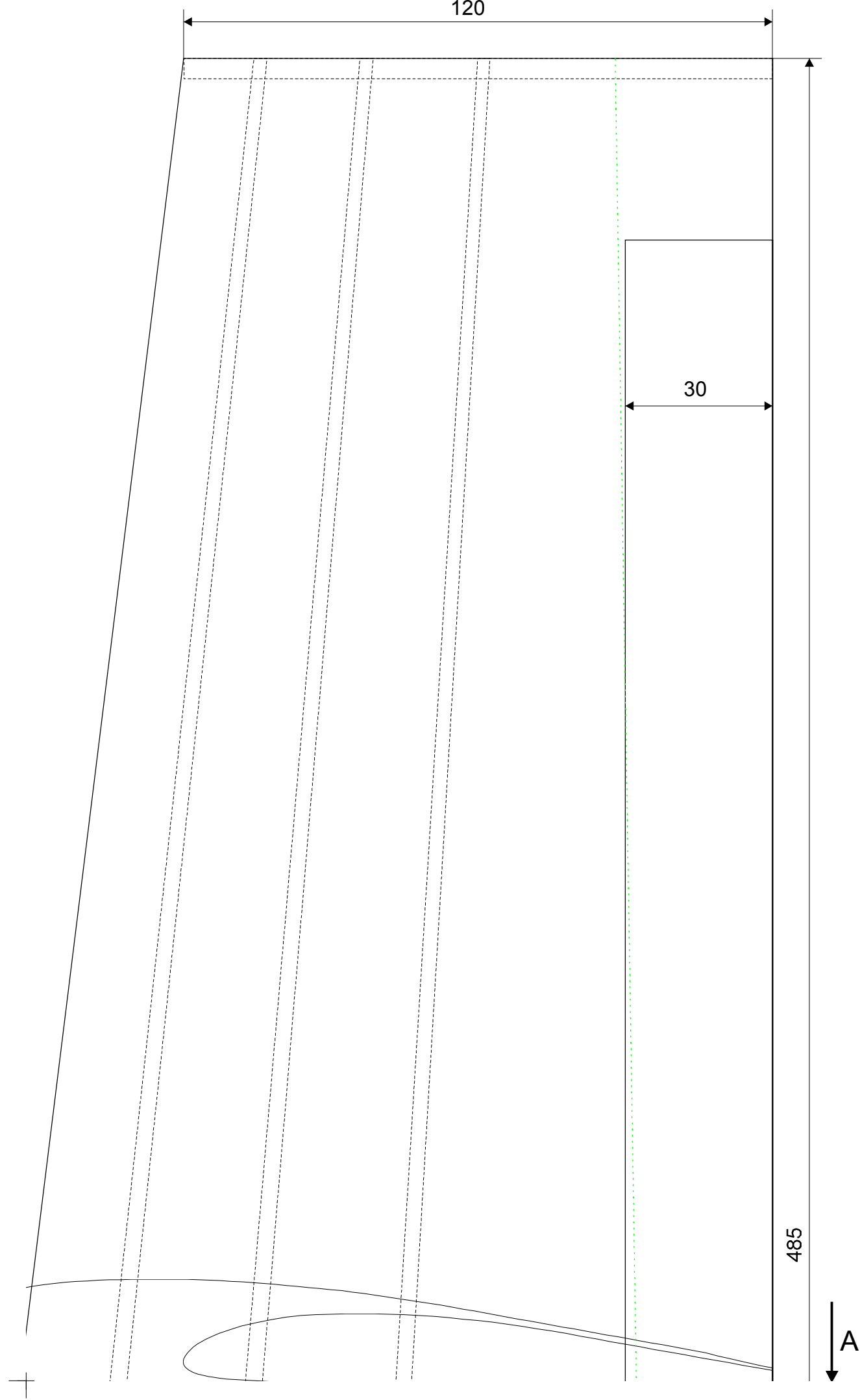

(3, 1)

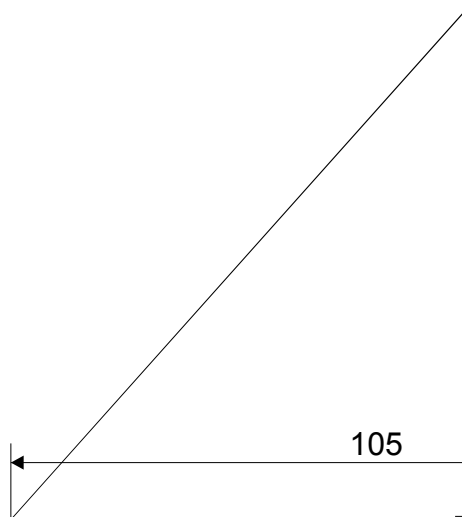

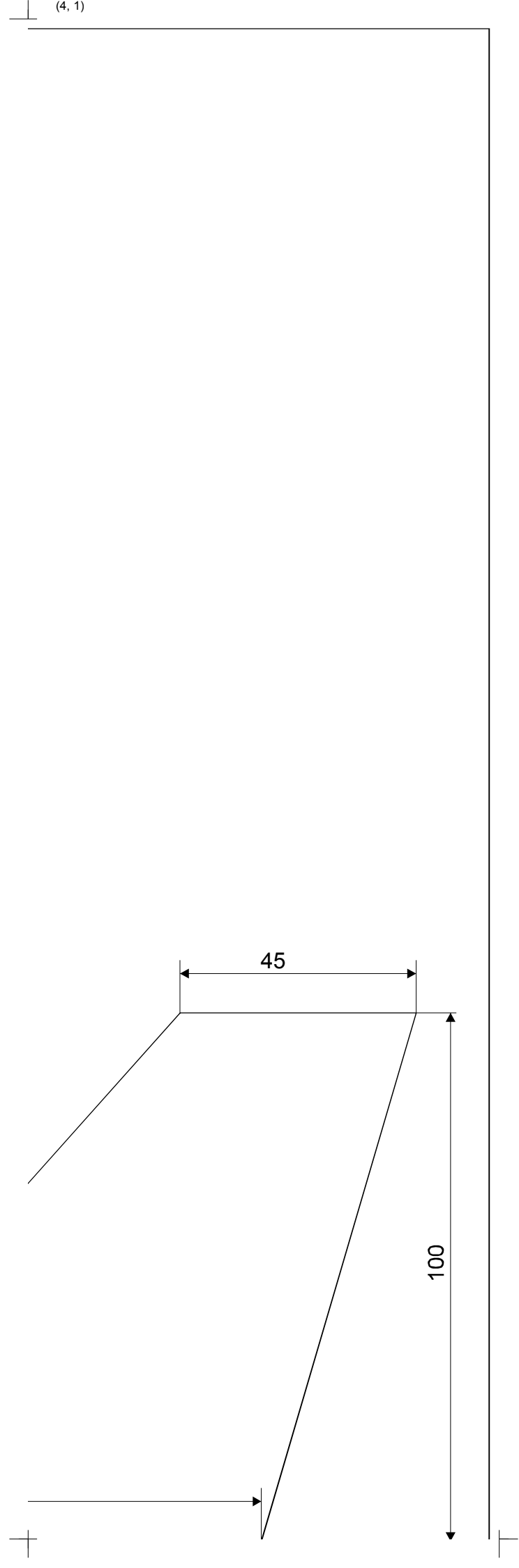

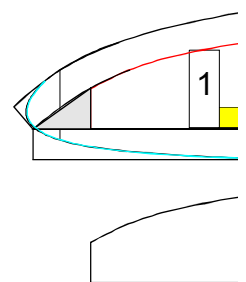
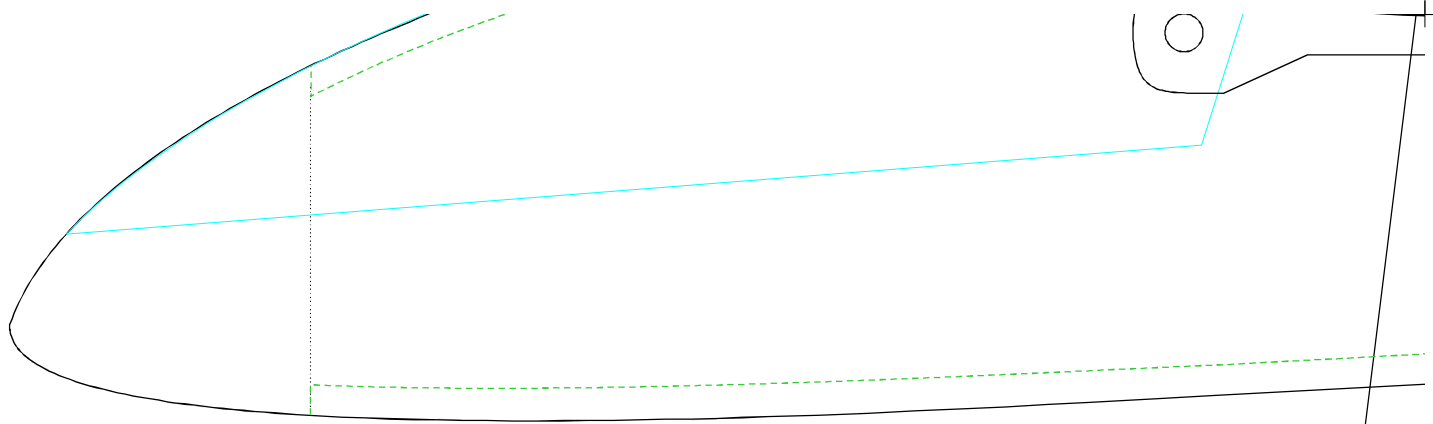

Technical drawing of a mechanical part, likely a bracket or support, showing a side view and a detail view.

The main view includes a curved base, a vertical section, and a horizontal section. Dimensions 180 and 660 are indicated.

A detail view shows a cross-section of a hole with a yellow highlight. Labels include:

- Хв\_
- Бок\_фюз
- Кр\_низ\_лев
- Кр\_верх\_прав
- Рис. 1000

660

3

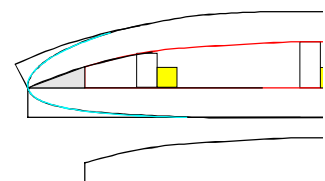

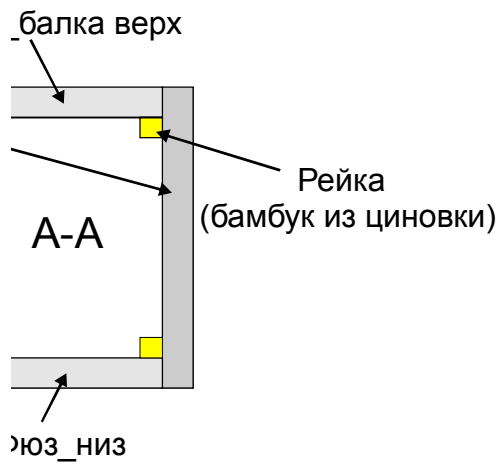

$L_{\text{фюз}}=660 \text{ мм}$   
 $L_{\text{кр}}=970 \text{ мм}$   
 $S_{\text{кр}}=14.55 \text{ дм}^2$   
 $S_{\text{ст}}=2.45 \text{ дм}^2$

Расположение деталей  
на листах потолочки

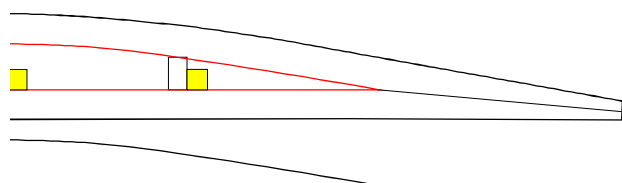

(4, 2)

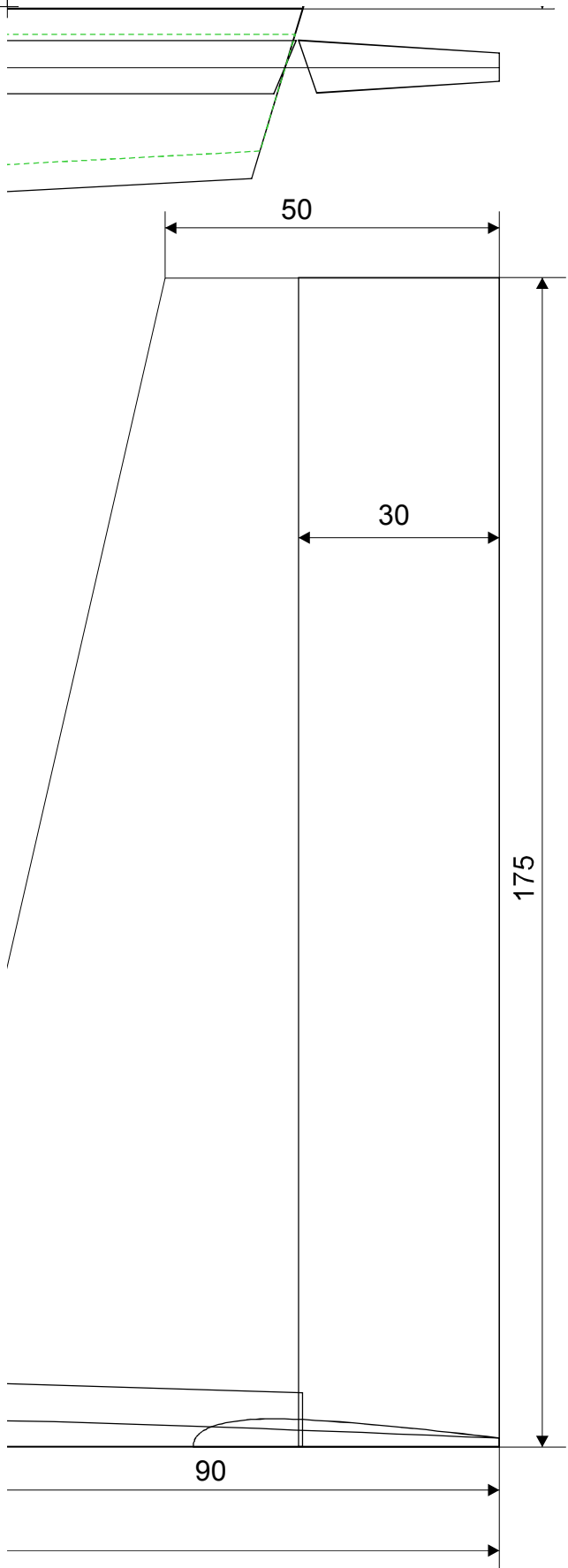



носовая обшивка вырезана  
из цельного куска плотного пенопласта

ЛН\_1 2 шт

ЛН\_2 2 шт

ЛН\_3 2 шт

Нос\_бобышка  
(пенопласт)\_бок

Фюз\_бок 2 шт

Фюз\_низ 1 шт

Нос\_верх 1 шт

Хв\_балка\_верх 1 шт

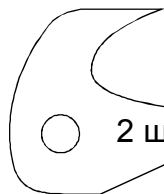

2 шт фанера 3 мм

(4, 3)

