

D

C

B

A

16

15

14

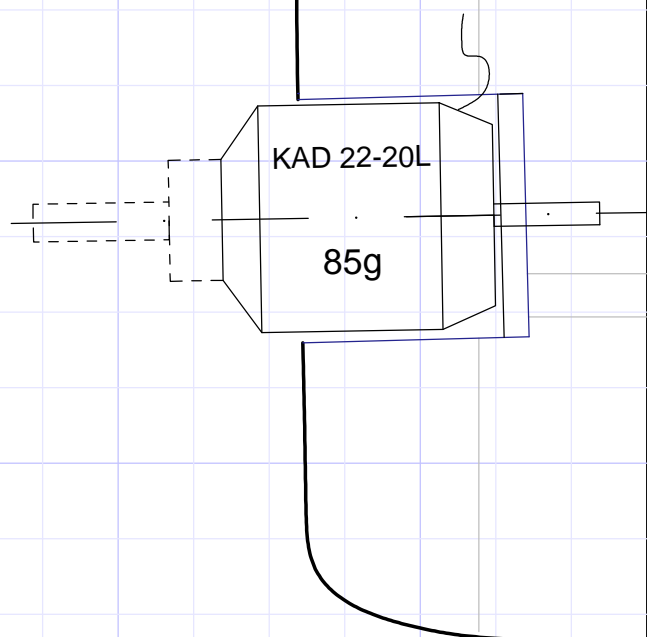

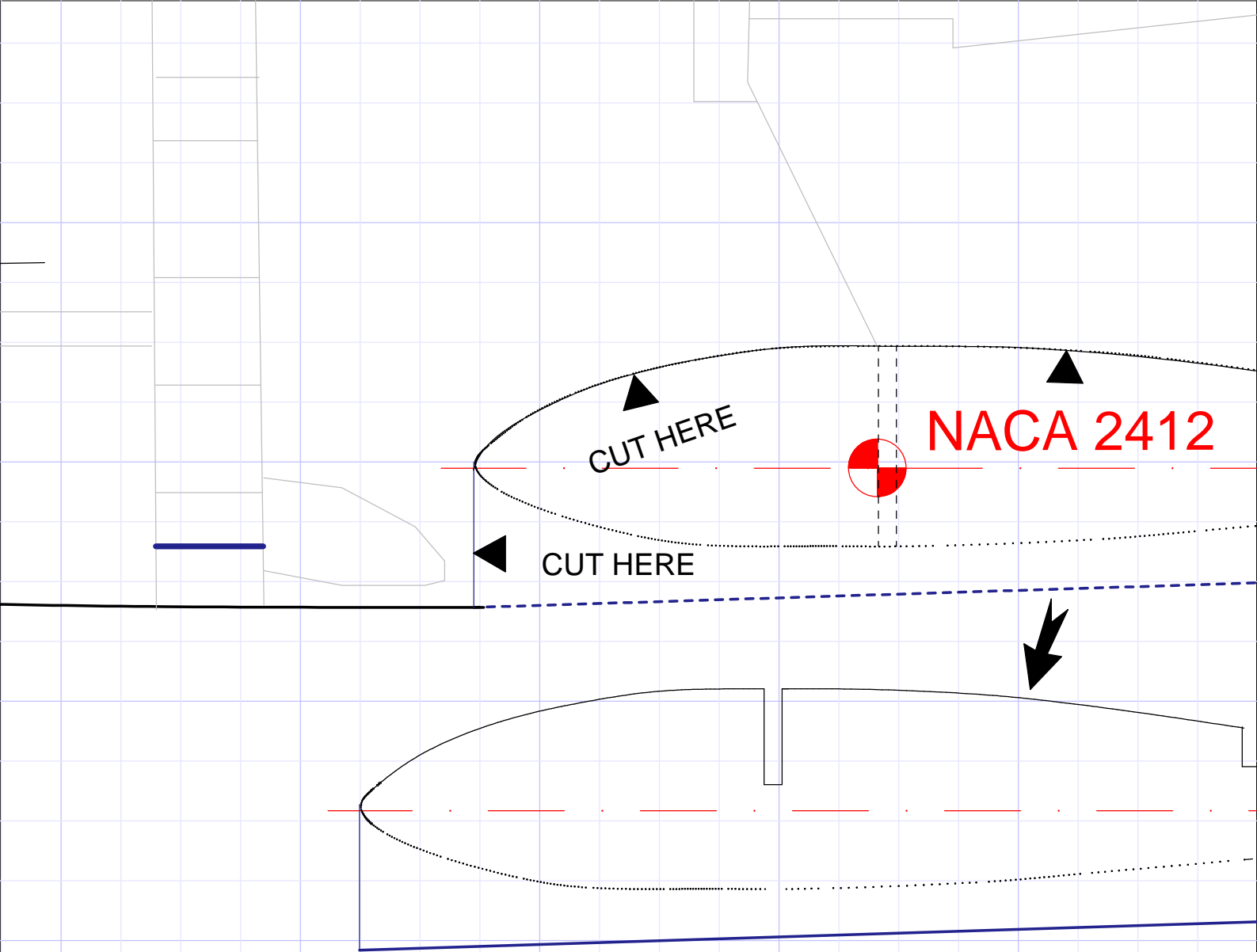

30mm styrofoam

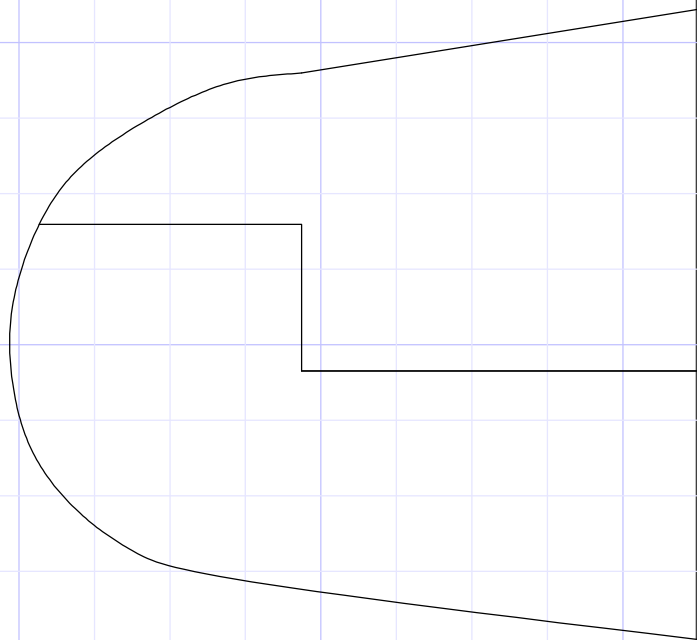
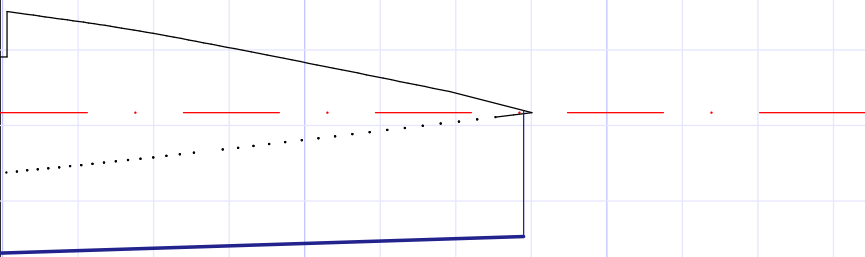
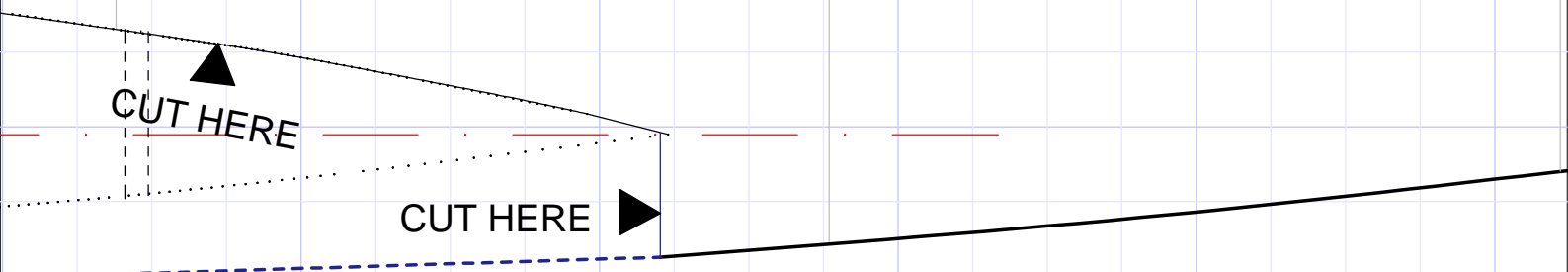

10

9



1.2°

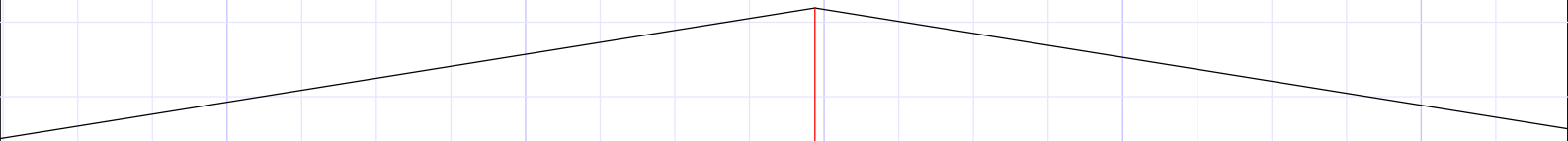
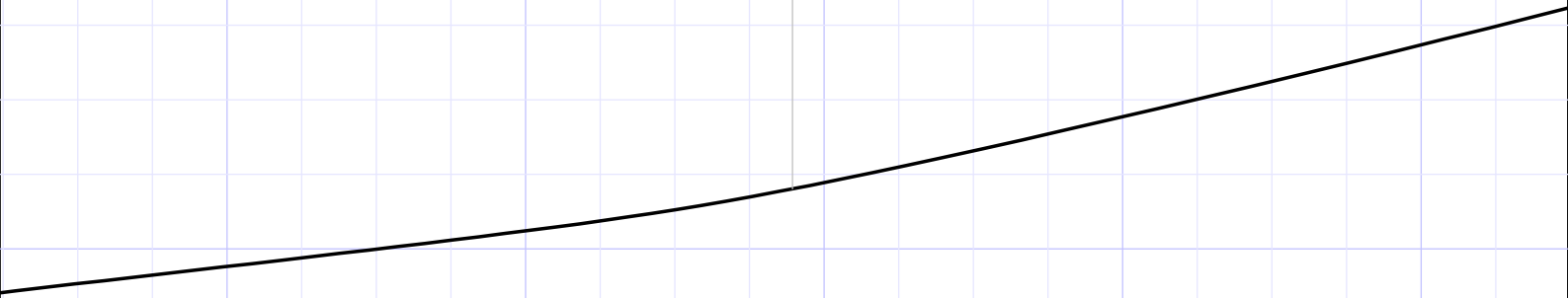
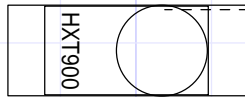

6 mm depron

Hard balsa or Carbon fiber tube



8

7

6

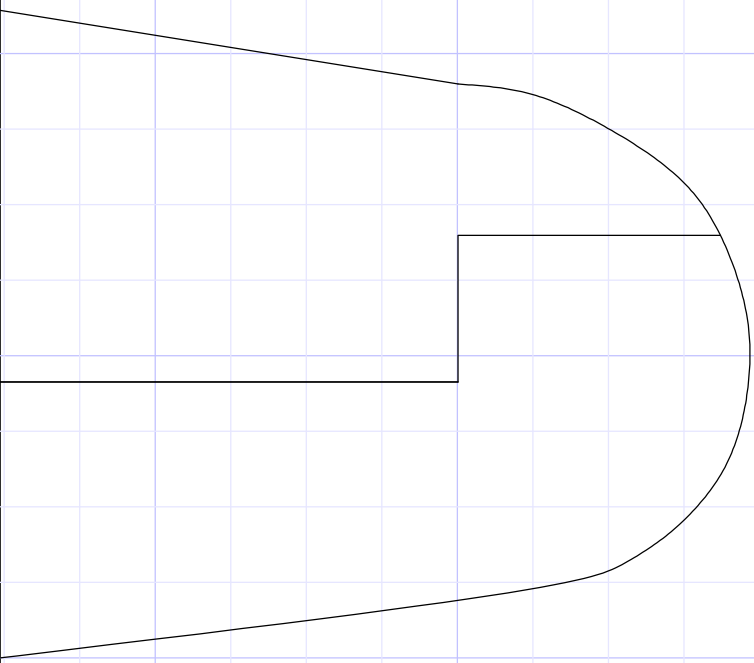
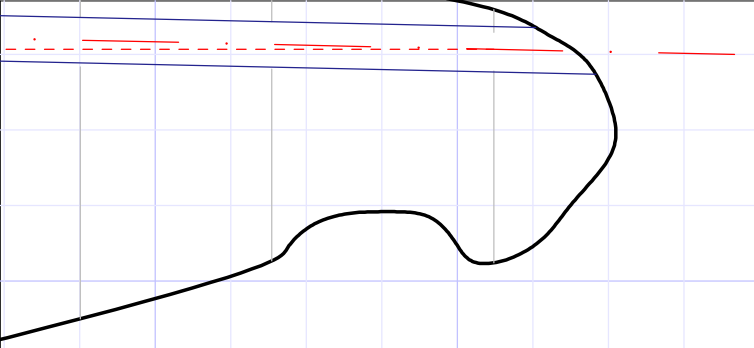

© Dreamcatcher  
August 2009

F4

TITLE  
Wing S  
Length  
Weight

SIZE

A0

SCALE

5

4

3

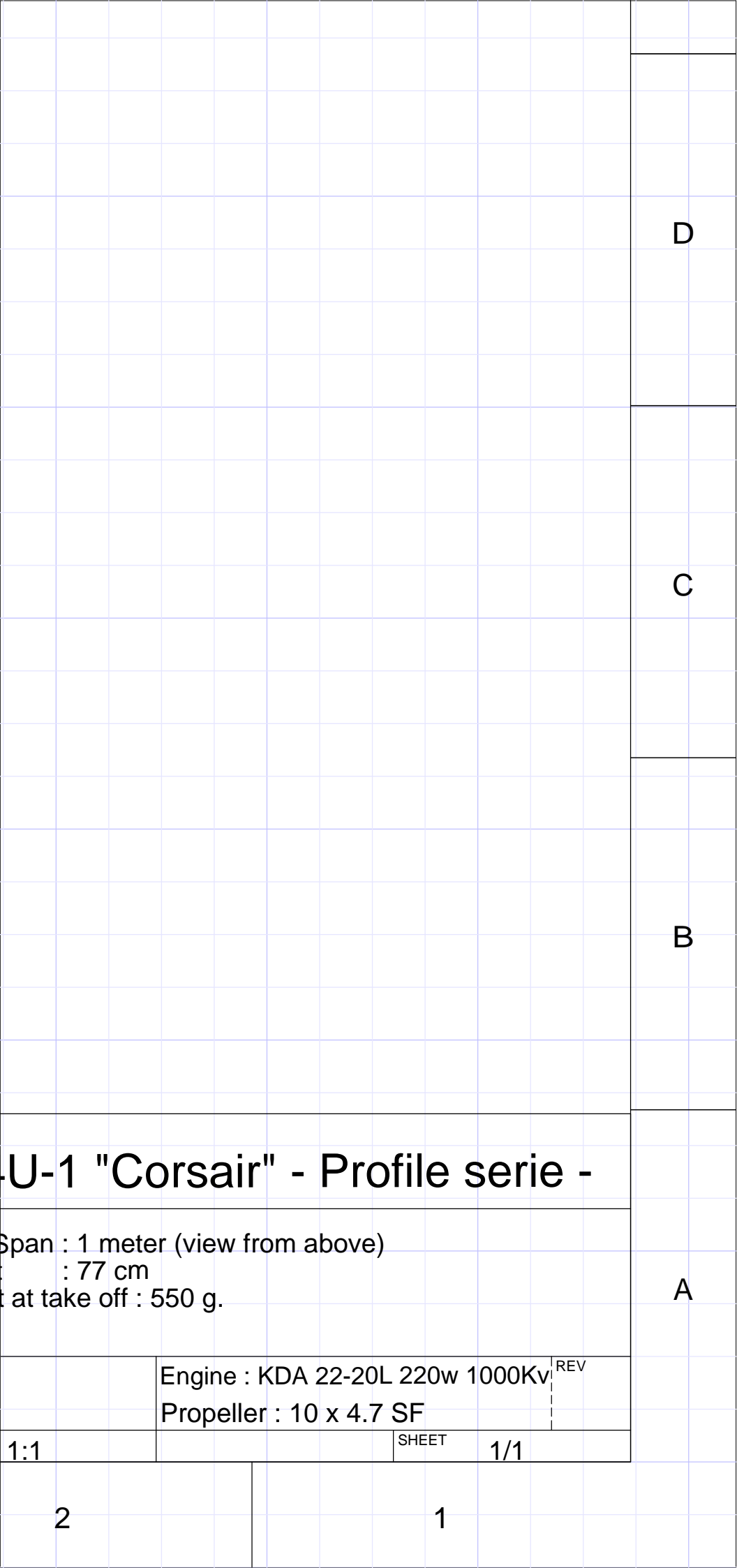

D

C

B

A

following this path after the

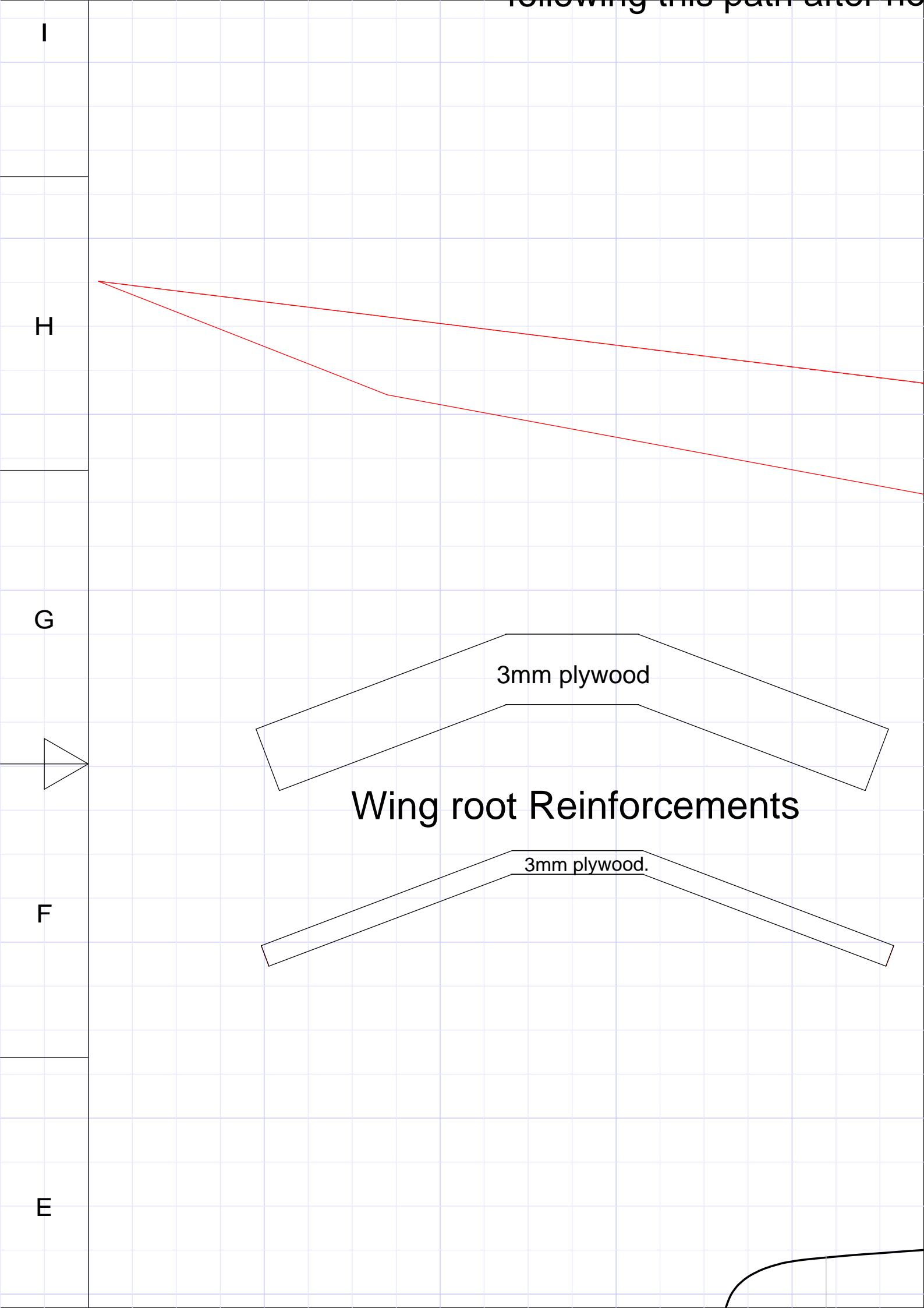

I

H

G

F

E

3mm plywood

3mm plywood.

Wing root Reinforcements

Wings pannels are h  
from a 50mm styrofo

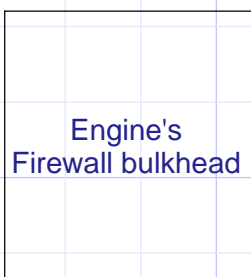
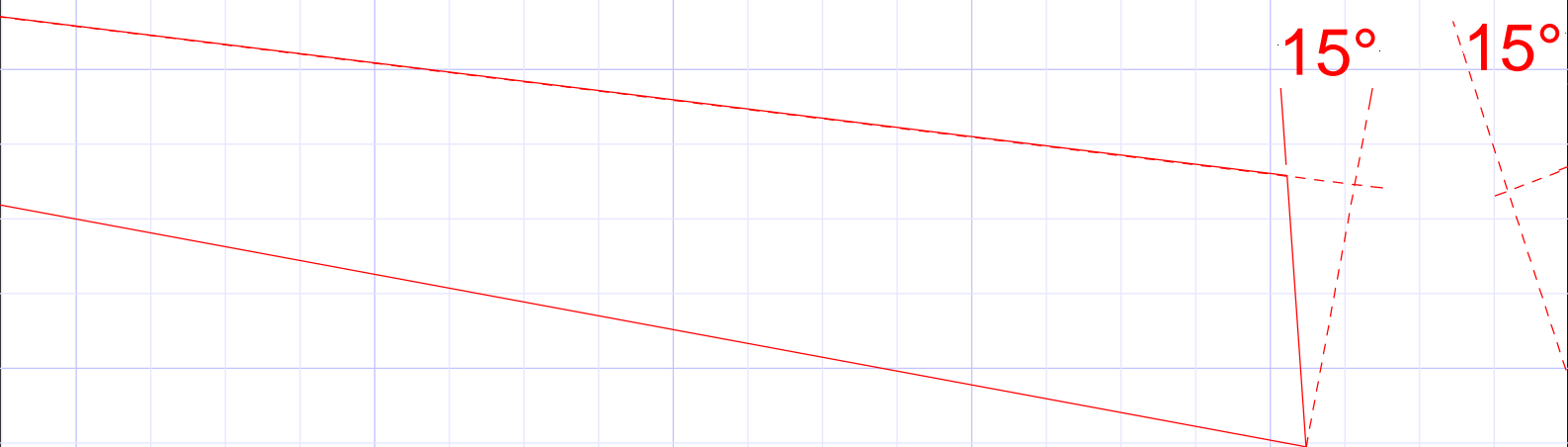

Engine's  
Firewall bulkhead

3mm plywood

If you enjoy this plan, please  
to the designer to show your  
into developing it. Suggest  
be sent via PayPal to pch2



# Hot wire cut lam board.

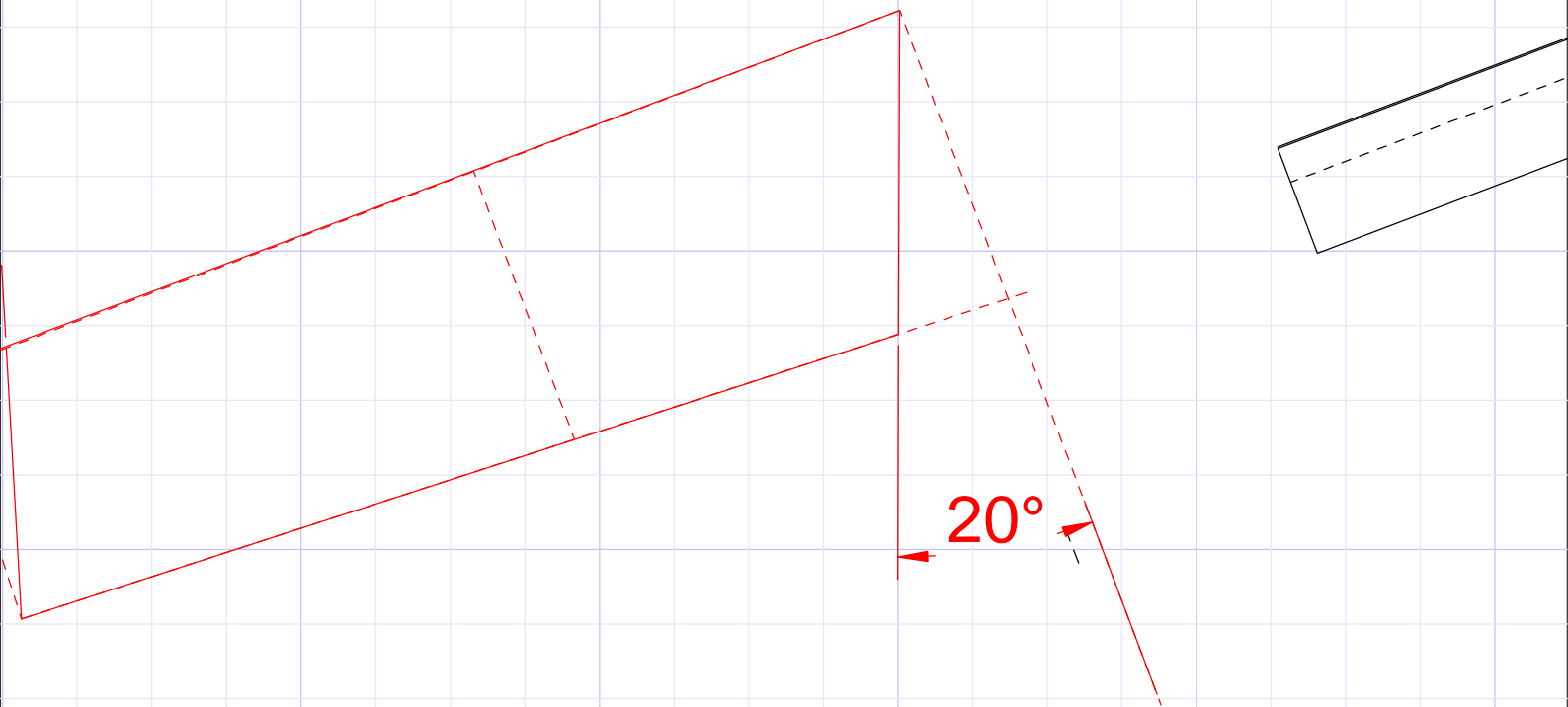

consider sending a small contribution  
appreciation for all the work that went  
ed contribution is \$10 U.S., and can  
2@free.fr. Thanks for your support !

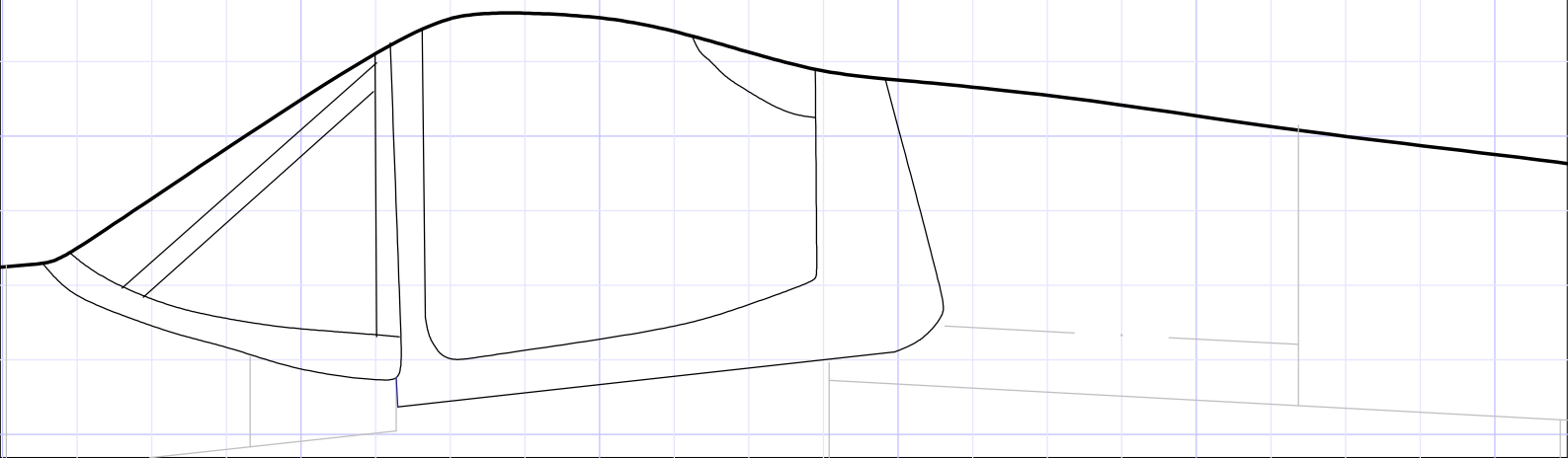

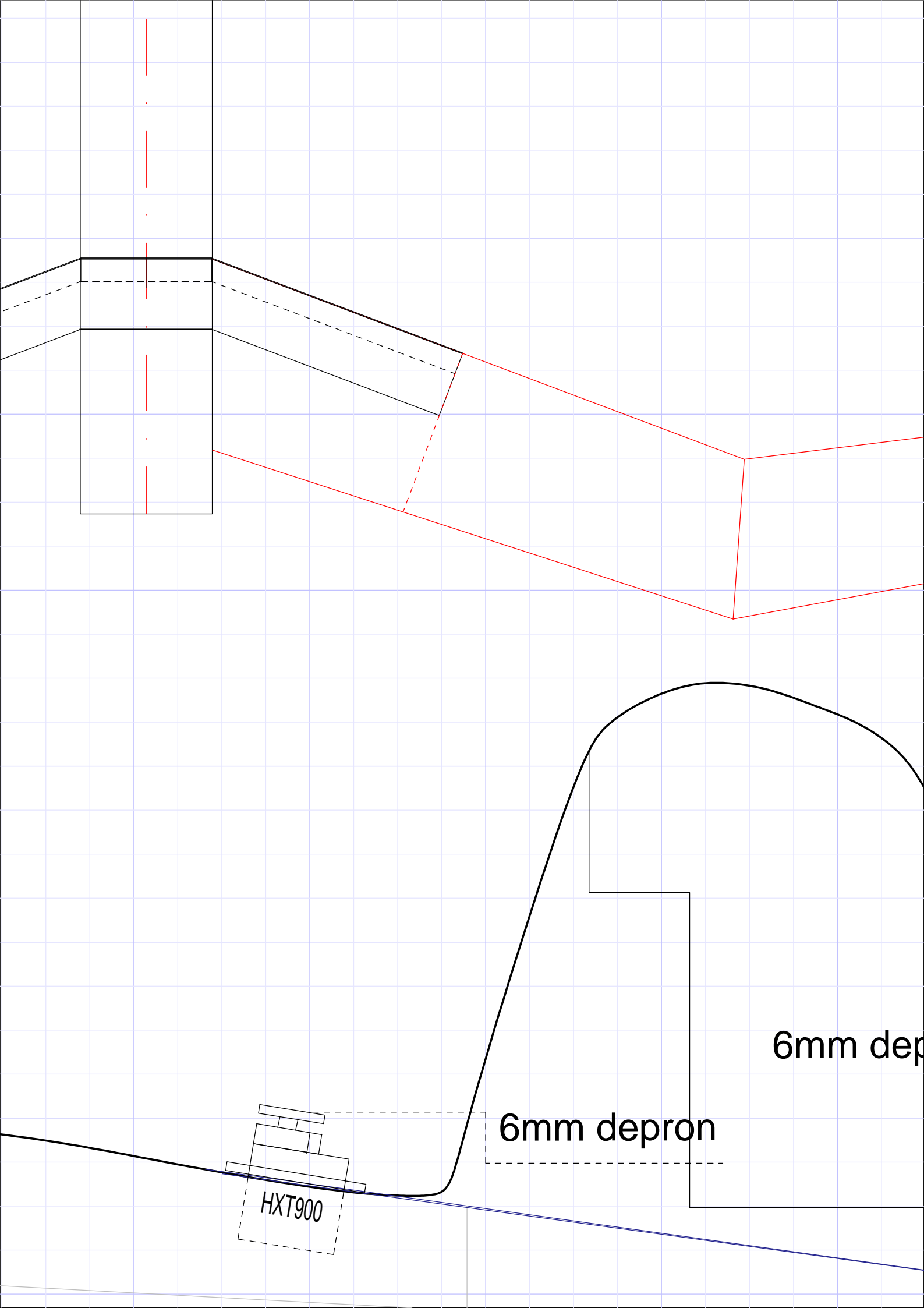

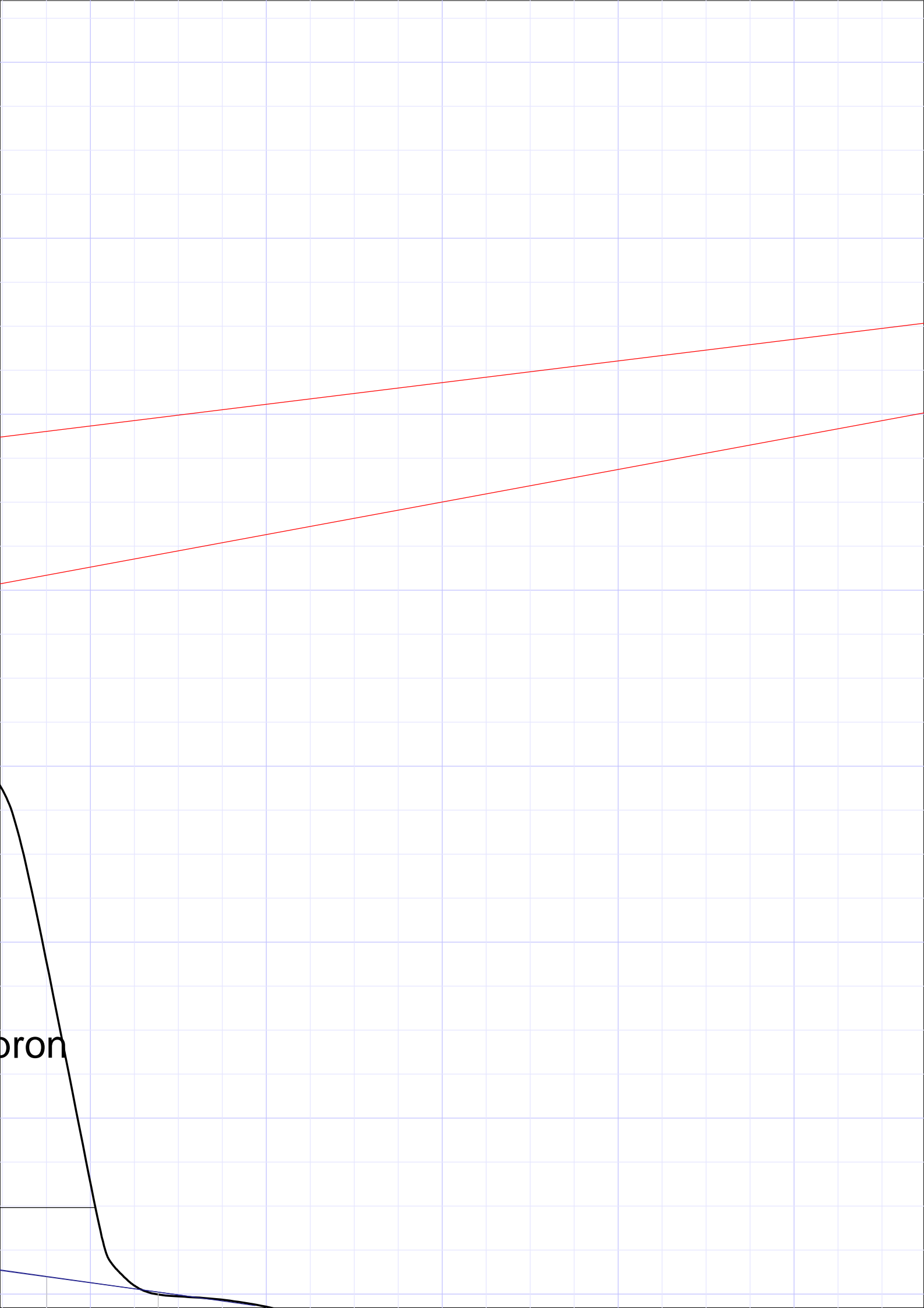

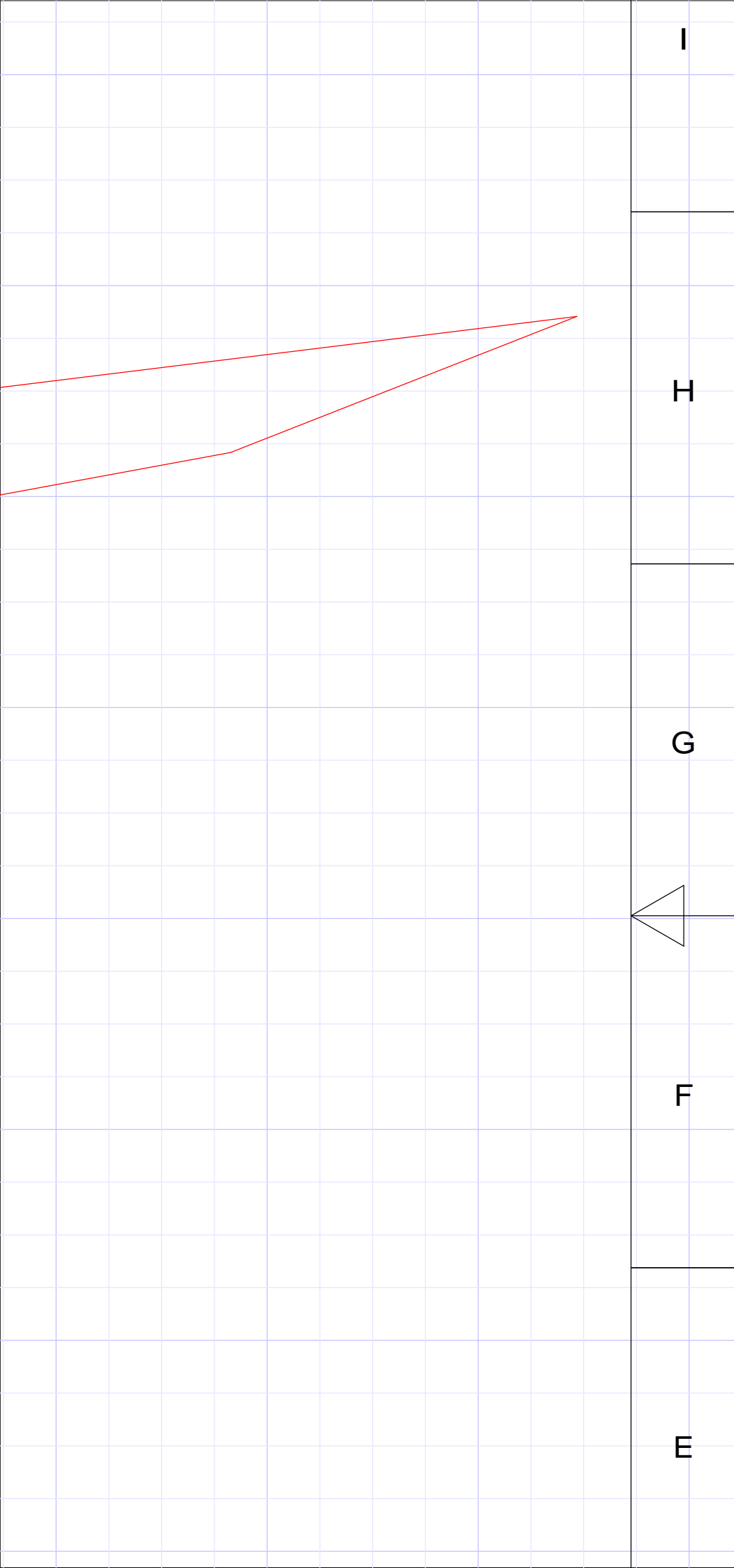

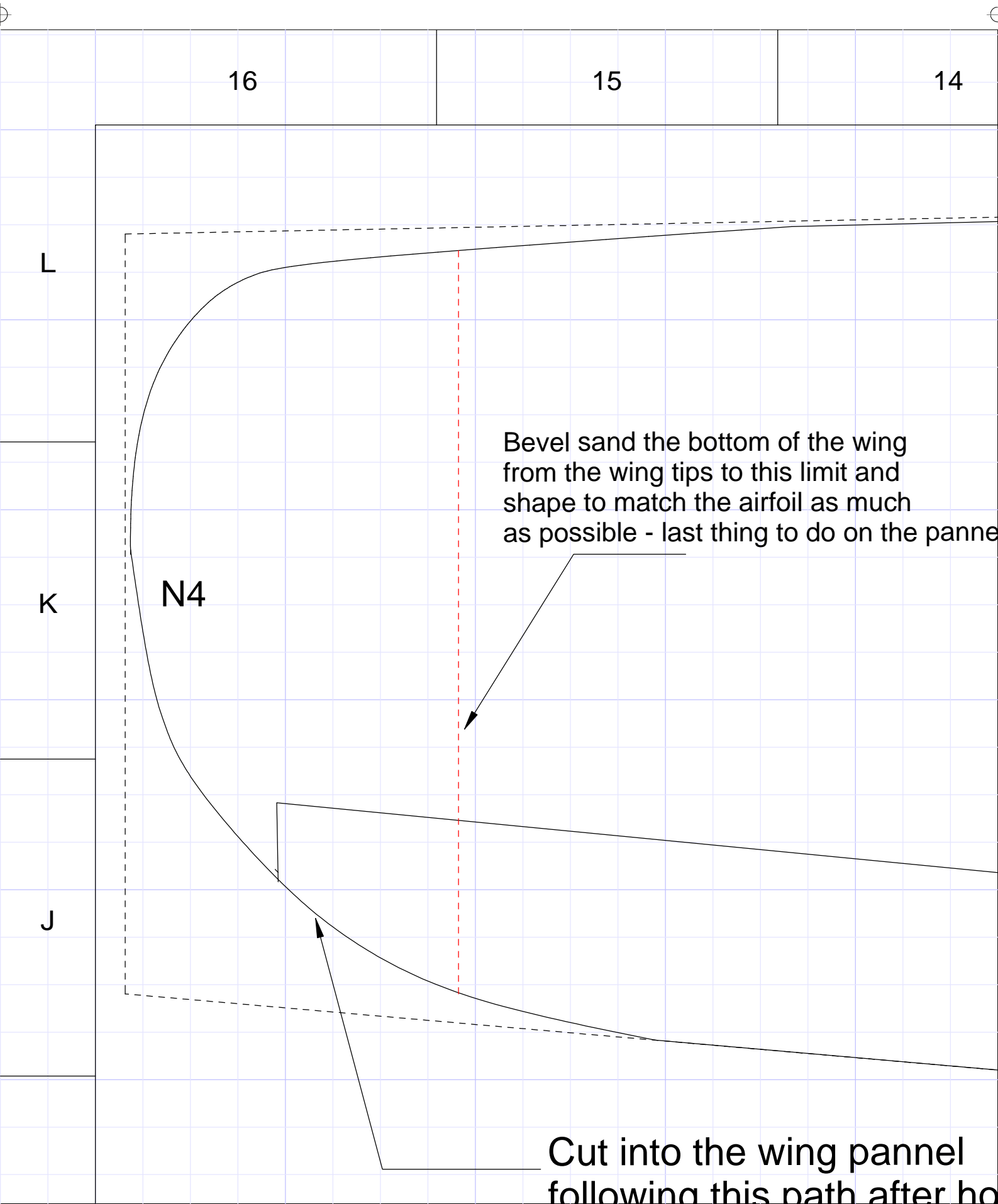

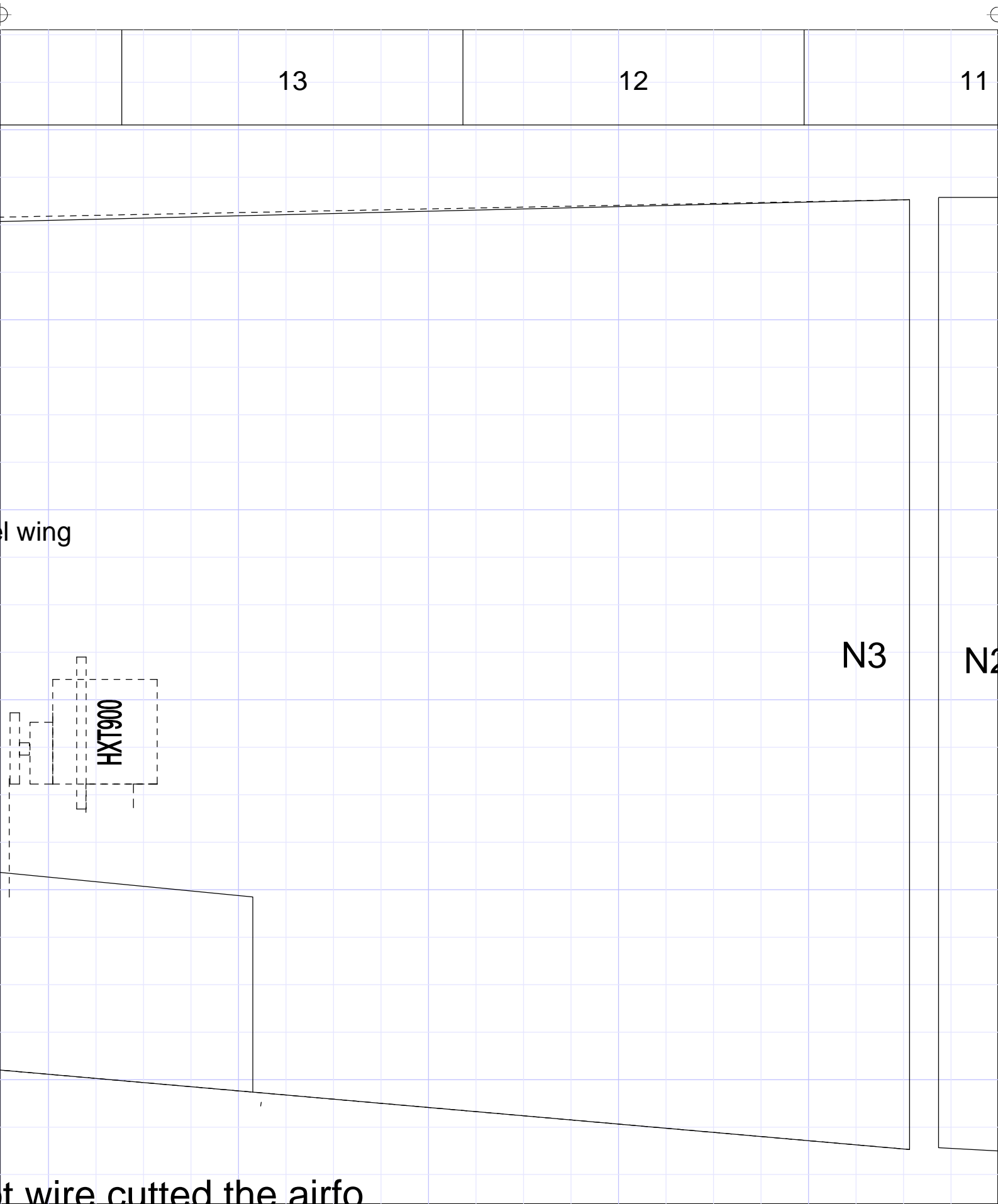

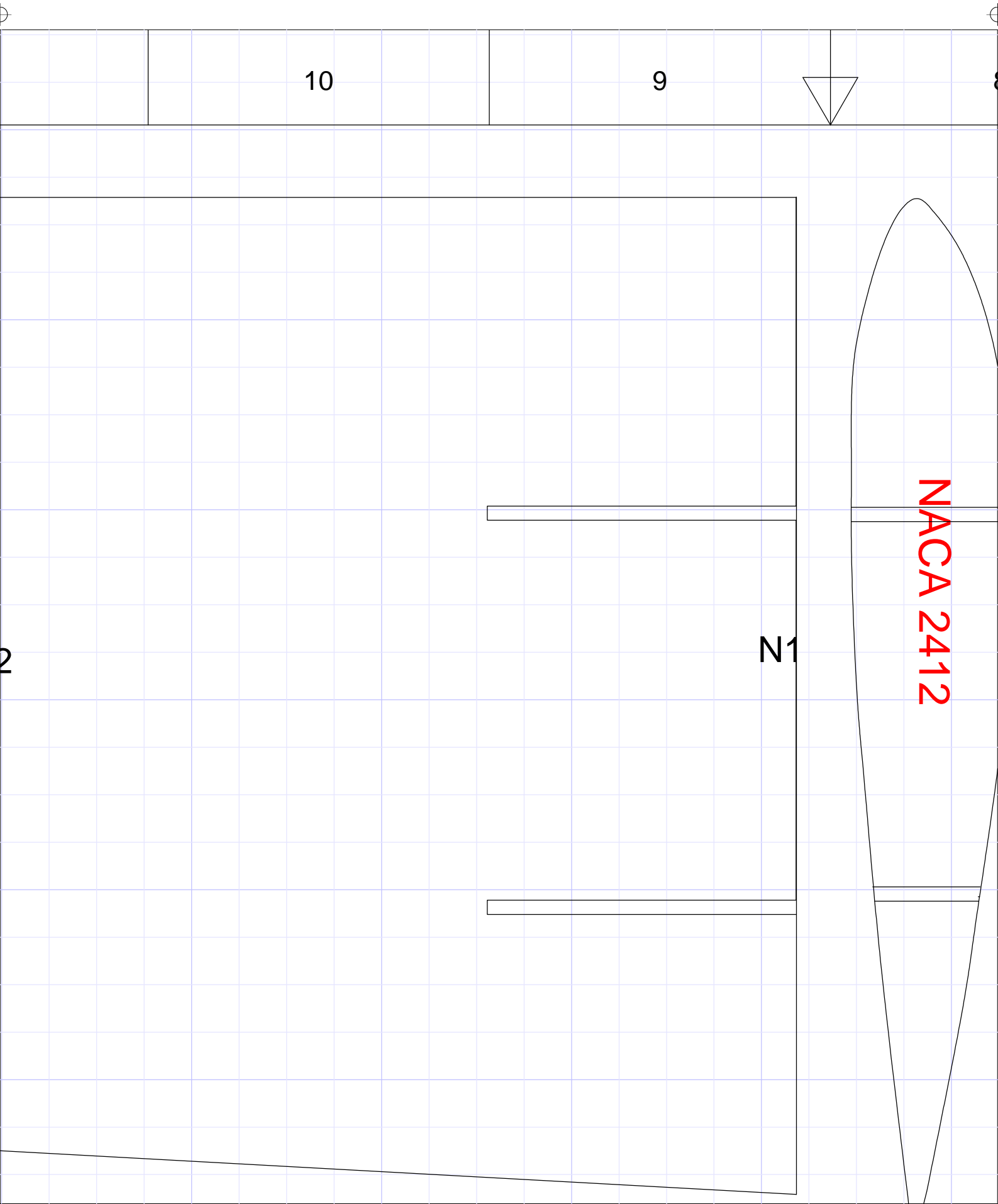

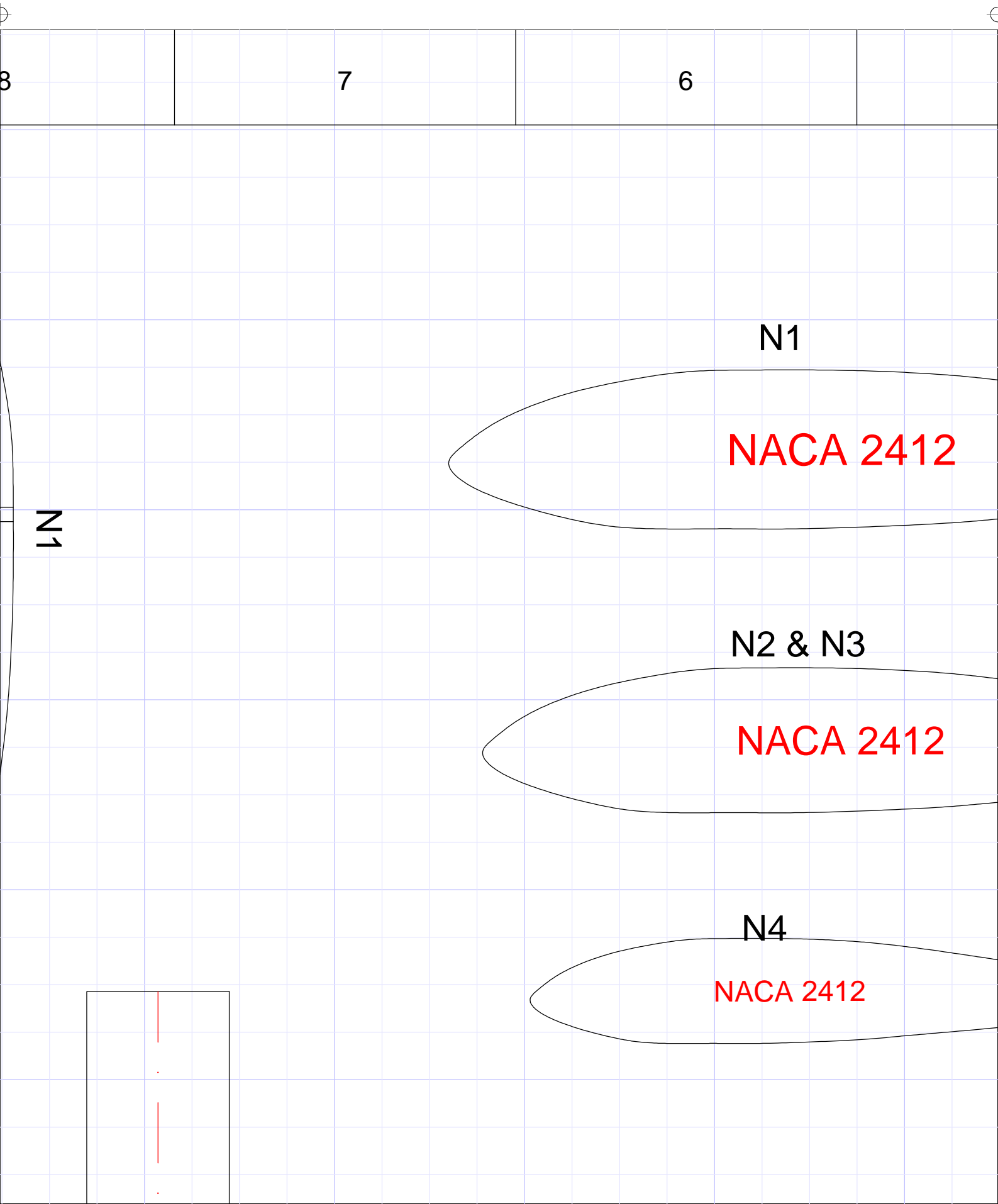



5		4		3	
---	--	---	--	---	--

